



WINDSWEPT
RESIDENCE CLUB

VILLA BOUGAINVILLEA



LEVEL 1





VILLA BOUGAINVILLEA

\$450,000 PER SHARE

DISTINCTIVE ELEMENTS

- ❖ Fully furnished
- ❖ Two master suites, each with direct access to outdoor living space
- ❖ Spacious guest rooms, sleeps up to 10 people
- ❖ Vaulted wood ceilings, heavy beam construction, and Wallaba roof shakes
- ❖ Natural stone flooring throughout
- ❖ Luxurious European kitchens with custom cabinetry, designer appliances, and quartz or stone countertops
- ❖ Spacious indoor living areas that open to terrace
- ❖ Full outdoor kitchen and bar
- ❖ Intimate, professionally landscaped gardens
- ❖ Outdoor living area with pool and stone decking
- ❖ Environmentally-minded design
- ❖ Energy Star standards
- ❖ Maintenance-free stucco finish
- ❖ Hurricane impact-rated windows, doors, and construction
- ❖ Expansive hillside, harbour, and ocean views
- ❖ Membership in the Christophe Harbour Club
- ❖ Short walk to The Pavilion beach club and future amenities
- ❖ Eligible for Citizenship by Investment

LEVEL 2

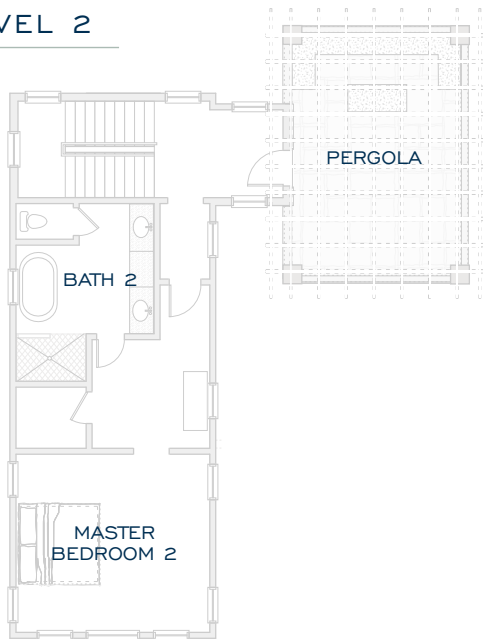

VILLA BOUGAINVILLEA

2 STORY PLAN

LIVING SPACE: 4535 SQ. FT. / 421.3 SQ. METERS

2ND FLOOR TERRACE: 326 SQ. FT. / 30.3 SQ. METERS

4 ENSUITE BEDROOMS

1 POWDER ROOM

SLEEPS UP TO 10 PEOPLE

